

Chapter 3. Initial setup

3.1 Introduction

This chapter provides instructions for programming the PT900 flow meter via the tablet app prior to initial operation.

3.2 Charging the PT900 transmitter and tablet

Before proceeding, make sure that both the PT900 transmitter and the tablet are fully charged. The AC power adapters are shipped in the carry case. If either the transmitter or the tablet cannot be powered on after charging, contact your Panametrics representative or visit www.gemeasurement.com for transmitter assistance or contact the tablet manufacturer for tablet assistance.

3.3 Installing or updating the PT900 app

The instructions in the following sections explain the procedures for downloading the current version of the PT900 app and installing it on your tablet.

3.3.1 Checking the app version

To check the app version currently on your tablet, click on the about option in the help menu to open a screen similar to Figure 53 below. This screen displays general information about the PT900. This information includes: model name, instrument type, software version, and the copyright year of the app.

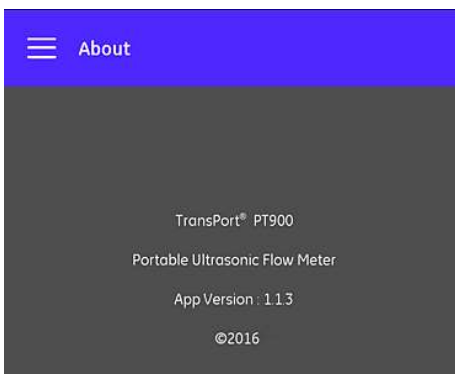

Figure 53: The about screen

3.3.2 Installing or updating the PT900 Android and iOS app

Update your existing PT900 app from one of the below options:

Android app

- **Google Play store:** To obtain a newer version of the app from Google Play store, search for “transport PT900” and

install it. Google Play store is the preferred method of installation because updates will automatically be loaded to your tablet with the latest version of the application.

- **QR code or Panametrics website:** To obtain a newer version of the app, scan the QR code in *Figure 54* below.



Figure 54: QR code

Alternatively, download the latest version of the app from the Panametrics website, go to the below URL and search for “TransPort PT900” <https://www.industrial.ai/download-center>

- **SD card:** To obtain a newer version of the app from an SD card, plug the SD card directly into the tablet. Then, select the APK file from the SD folder.

iOS app

- **Minimum iOS device requirements:** device should have
 - BLE 4.city: 16GB and above
- **Apple app store:** To obtain a newer version of the app from Apple app store, search for “Transport PT900” and install it. Apple app store is the only method to install the iOS application and updates will automatically be loaded to your tablet with the latest version of the application.

3.3.3 Installing the tablet app from the SD card (applicable only to Android app)

To install the app, complete the following steps:

1. Open the “my files” folder on the tablet screen and select the app from the SD folder (see *Figure 55* at right).
2. In the tablet settings, enable the security option to allow the installation of software from “unknown sources” for this installation only (see *Figure 56* at right).
3. Click on the APK file, and the Android operating system will verify the checksum and signature for the file. Depending on whether this is an initial installation or an update installation, you will see one of the screens shown in *Figure 57* at right. Click *install* to begin the installation.

NOTE: If the file signature is not verified, the app will be treated by the Android operating system as an unrecognized app.



Figure 55: The “my Files” folder

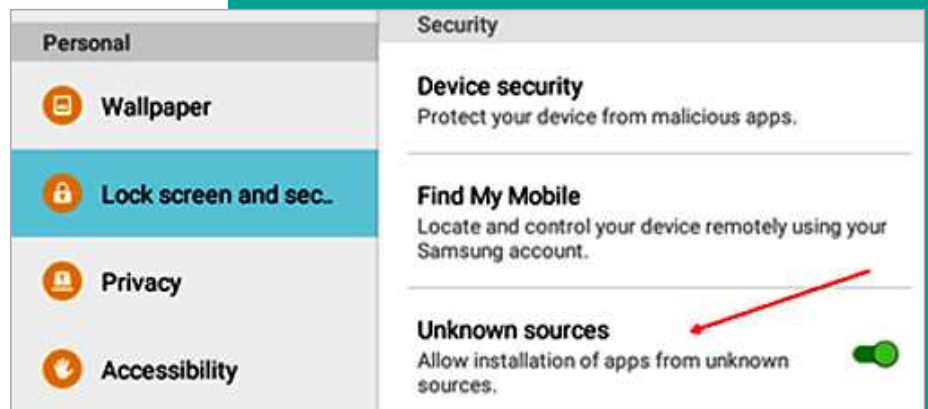

Figure 56: Security settings

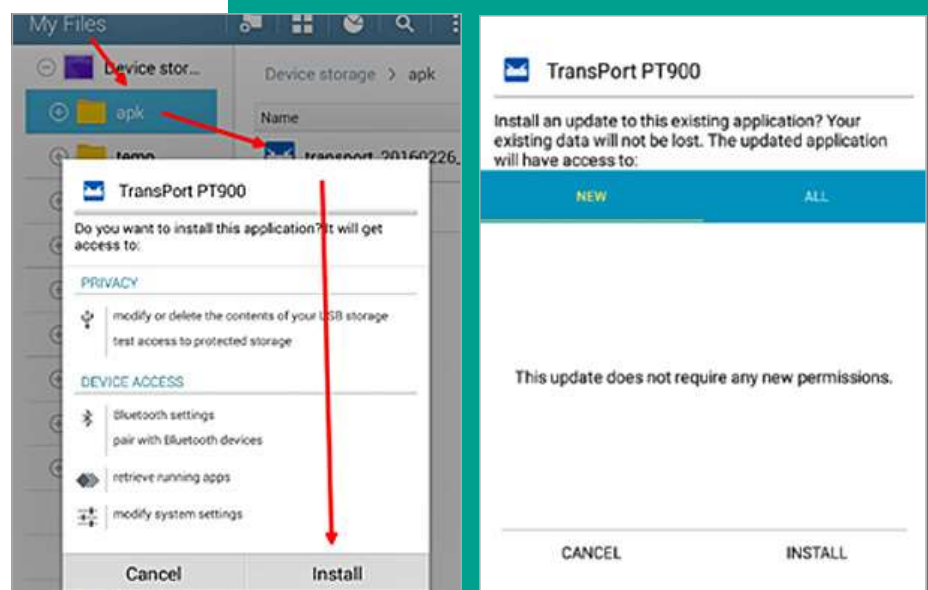

Figure 57: Initial (left) and update (right) installation screens